

FOR SALE

RESIDENTIAL - EXECUTIVE CONDO 1,399SQFT (130SQM) / CALL FOR PRICE!

+65 9088 0558



4 - Bedroom Grande

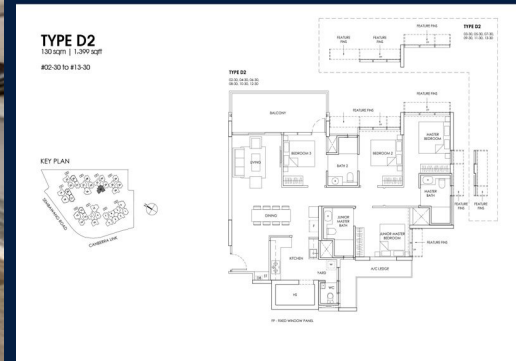

RESIDENTIAL - EXECUTIVE CONDO

23, 25, 27, 29, 31, 33, 35, 37, 39 CANBERRA LINK,
YISHUN, SEMBAWANG, SINGAPORE 757079

- LISTING ID: SGLD54232312
- TENURE: LEASEHOLD 99
- TITLE: N/A
- SIZE BUILT-UP: 1,399SQFT (130SQM)
- SIZE LAND: 4.124AC (1.669HA)
- NO. OF FLOORS: 13
- FLOOR/LEVEL: N/A - N/A
- BED ROOMS: 4
- BATH ROOMS: 4
- MAIDS ROOMS: N/A
- PARKING SPACES: N/A
- LAYOUT TYPE: OTHER
- FACING: N/A
- VIEWING: OTHER
- SELLING PRICE: **CALL FOR PRICE!**
- COMPLETION YEAR: 2026
- CONDITION: ORIGINAL CONDITION
- FURNISHING: PARTIALLY FURNISHED
- LISTING DATE: JUL 16, 2021

PROVENCE RESIDENCE

Executive Condo for Sale: Partially furnished, 4 bedroom, 4 bathroom. Completed in 2026, this unit is in original condition. Tenure: Leasehold 99 Located in Singapore's district D27 near Sembawang, Yishun in the area Far North (North region).

INTERIOR FACILITIES

- Air-Conditioning
- Bombshelter
- Balcony

OTHER INTERIOR FEATURES

- Cooker Hob/Hood
- Oven / Microwave
- Intercom

EXTERIOR FACILITIES

- 24 Hours Security
- Covered Car Park
- Basketball Court
- Function Room

VISIT THIS PROPERTY AT: <https://www.shawnsharan.com/property/SGLD54232312>

SHAWN SHARAN - HUTTONS ASIA PTE LTD

3 Bishan Place #05-01 CPF Bishan Building
D20, 579838, Singapore

+65 9088 0558
WhatsApp Me

chugani2@gmail.com

<https://www.shawnsharan.com>



Scan QR Code

Huttons® Call for Viewing
The Agency of Choice +65-90880558